

# Government of the District of Columbia

## Department of Transportation



September 12, 2017

Zach Teutsch  
Advisory Neighborhood Commission 4C  
1323 Shepherd Street NW  
Washington, DC 20011  
[4C05@anc.dc.gov](mailto:4C05@anc.dc.gov)

**Re: Sherman Circle Transportation Safety Improvements  
NOI #17-127-PSD**

Dear Chairperson Teutsch:

Pursuant to the "Administrative Procedure Amendment Act of 2000" D.C. LAW 13-249 (48 DCR 3491 April 20, 2001), the District Department of Transportation (DDOT) is required to give a written notice of our intent to modify traffic and/or parking requirements. This letter is being forwarded to you for the purpose of notification and solicitation of comments on our intent to implement the following modifications in your jurisdiction:

- **Implementation of the Sherman Circle NW Bike/Pedestrian Safety Improvement Plan**

This modification is a result of analysis performed by DDOT to advance recommendations from the Rock Creek East II Livability Study, and from subsequent community engagement. The analysis was presented to the community on July 26, 2017. An executive summary outlining the proposed change to traffic operations was sent to the ANC as an accompaniment to this Notice of Intent.

DDOT's proposed recommendation for Sherman Circle is to reduce one travel lane around the circle, and redesign it to include a variety of treatments to address safety concerns and manage vehicular traffic. These treatments are detailed in the Sherman Circle NW Bike/Pedestrian Safety Improvement Plan, which is attached to this letter. The treatments include:

- Install edgeline and "zebra" curb-stops 10 feet off curb to narrow Circle from two travel lanes to one.
- Install a bicycle lane around the Circle, with a two-foot buffer from the adjacent travel lane. Flexposts will be installed in the buffer where the bicycle lane is not adjacent to on-street parking or a bus stop zone.
- Convert all approaches to the Circle to yield control.
- Install planters on each side of crosswalks adjacent to the Circle park.
- Install high-visibility striping in existing crosswalks.
- Reduce the turning radii at exits of Circle to calm traffic and improve safety at crosswalks.
- Shorten the pedestrian crossing distance at crosswalks.
- Maintain existing parking capacity at the circle.

All comments on this subject matter must be filed in writing, no later than thirty (30) days after the date of this notice, with the District Department of Transportation (DDOT), Planning and Sustainability Division at 55 M Street SE, Washington, DC 20003. Comments may also be sent via email to Ted Van Houten at [theodore.vanhouten@dc.gov](mailto:theodore.vanhouten@dc.gov). To check the status of this Notice of Intent (NOI), please visit DDOT's website at: <http://ddot.dc.gov/service/ddot-notice-intent>

Sincerely,

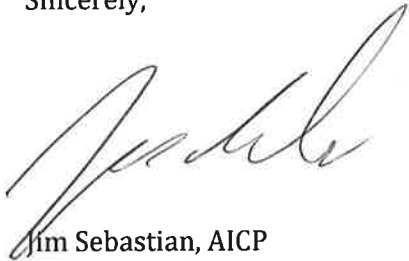

Jim Sebastian, AICP  
Associate Director  
Planning and Sustainability Division

Attachment: Sherman Circle NW Bike/Pedestrian Safety Improvement Plan

cc: Lisa Colbert, Chairperson, Advisory Neighborhood Commission 4D

# Government of the District of Columbia

## Department of Transportation



September 12, 2017

Zach Teutsch  
Advisory Neighborhood Commission 4C  
1323 Shepherd Street NW  
Washington, DC 20011  
[4C05@anc.dc.gov](mailto:4C05@anc.dc.gov)

**Re: Sherman Circle Transportation Safety Improvements**

Dear Chairperson Teutsch:

The following letter is being sent in order to update you on the progress of the District Department of Transportation's (DDOT's) work to improve transportation safety at Sherman Circle. A map of the area is shown in Figure 1.

*Background*

DDOT evaluated Sherman Circle as part of the Rock Creek East II Livability Study, which was completed in 2016. The study recommended the reduction of one travel lane in Sherman Circle to increase pedestrian and bicyclist safety as well as calm traffic.

Residents expressed overall support for the Sherman Circle recommendation in the Livability Study, but the proposed timeline (4-8 years) for full construction of improvements frustrated the community given the immediate desire to slow cars and improve safety. Some residents have expressed concern about reducing a lane at Sherman Circle and the potential impacts on the overall transportation network. In May 2017, ANC 4D Commissioner Amy Hemingway invited DDOT to a site visit at Sherman Circle in response to community concerns about safety. DDOT was asked by the community to explore options to implement improvements at Sherman Circle in the near-term.

DDOT has developed conceptual designs for Sherman Circle and performed an operational analysis on what a reduction to one travel lane would mean for traffic operations at Sherman Circle and in the surrounding neighborhood. The results of the analysis indicated that reducing a travel lane at Sherman Circle would have minimal impacts on traffic flow, vehicular delays, and queues. These results support the feasibility of reducing Sherman Circle to one lane.

At a public meeting on July 26, 2017, DDOT presented the results of the analysis to the community. Community support for reducing Sherman Circle to one lane was mixed. Some residents asked DDOT to perform a trial of the proposed lane reduction at Sherman Circle, an approach that was supported by Councilmember Todd's office and Commissioner Hemingway.

After considering this feedback, DDOT committed to performing this trial, and moved forward with a temporary closure of one lane at Sherman Circle. This closure began on September 11, 2017, and

will be in place for at least three weeks. During this time, DDOT will be collecting additional data and performing site visits and observations. DDOT will analyze the data collected during the trial period and share the results with the community.

#### *Proposed Recommendations*

DDOT's proposed recommendation for Sherman Circle is to reduce one travel lane around the circle, and redesign it to include a variety of treatments to address safety concerns and manage vehicular traffic. These treatments are detailed in the Sherman Circle NW Bike/Pedestrian Safety Improvement Plan, which is attached to this letter. The treatments include:

- Install edgeline and "zebra" curb-stops 10 feet off curb to narrow Circle from two travel lanes to one.
- Install a bicycle lane around the Circle, with a two-foot buffer from the adjacent travel lane. Flexposts will be installed in the buffer where the bicycle lane is not adjacent to on-street parking or a bus stop zone.
- Convert all approaches to the Circle to yield control.
- Install planters on each side of crosswalks adjacent to the Circle park.
- Upgrade the existing crosswalks around the Circle to ladder markings to improve visibility.
- Reduce the turning radii at exits of Circle to calm traffic and improve safety at crosswalks.
- Shorten the pedestrian crossing distance at crosswalks.
- Maintain existing parking capacity at the circle.

In addition to the improvements outlined above, DDOT is considering the following improvements that could be installed to further calm traffic in the neighborhood, if necessary:

- Install additional flexposts at turns to slow cars exiting the Circle.
- Install additional signage and markings at crosswalks to enhance transportation safety.

DDOT will analyze data collected during the temporary lane closure at Sherman Circle, and will consider all community feedback received. All data and community feedback will be taken into account as DDOT makes a final recommendation.

This letter serves as an accompaniment to the Notice of Intent (NOI) for the above outlined improvements. The NOI has been forwarded to you on the date of this letter, at which time comments will be formally solicited on the intent to modify the operations at this location.

If you have any questions concerning this letter, please feel free to contact Ted Van Houten at [theodore.vanhouten@dc.gov](mailto:theodore.vanhouten@dc.gov) or (202) 671-4580.

Sincerely,



Jim Sebastian, AICP  
Associate Director  
Planning and Sustainability Division

**Attachment: Sherman Circle NW Bike/Pedestrian Safety Improvement Plan**

**cc: Lisa Colbert, Chairperson, Advisory Neighborhood Commission 4D**

**Figure 1: Sherman Circle Area Map**

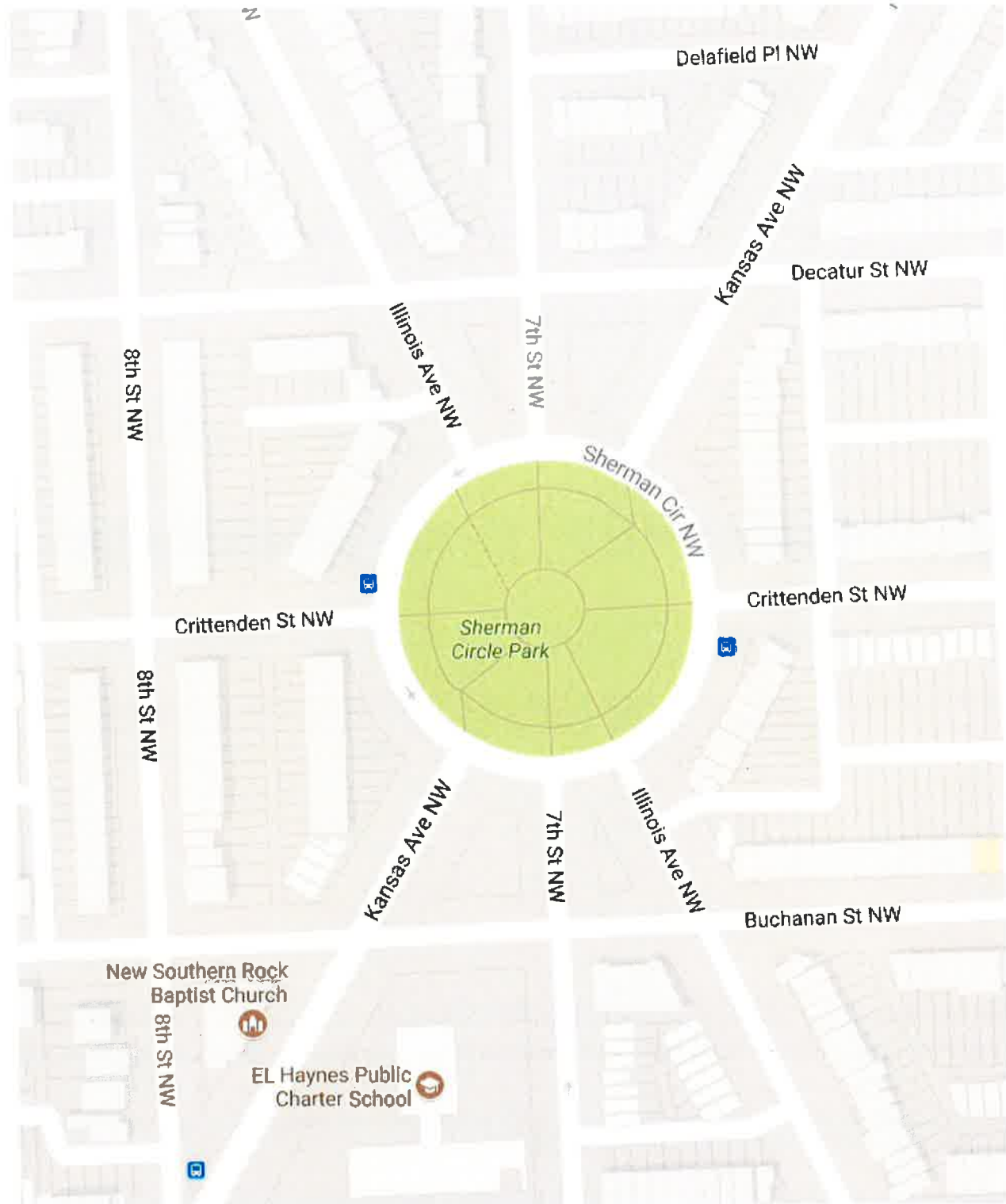

# Government of the District of Columbia

## Department of Transportation



September 12, 2017

Lisa Colbert  
Advisory Neighborhood Commission 4D  
601 Gallatin Street NW  
Washington, DC 20011  
[4D03@anc.dc.gov](mailto:4D03@anc.dc.gov)

**Re: Sherman Circle Transportation Safety Improvements  
NOI #17-127-PSD**

Dear Chairperson Colbert:

Pursuant to the "Administrative Procedure Amendment Act of 2000" D.C. LAW 13-249 (48 DCR 3491 April 20, 2001), the District Department of Transportation (DDOT) is required to give a written notice of our intent to modify traffic and/or parking requirements. This letter is being forwarded to you for the purpose of notification and solicitation of comments on our intent to implement the following modifications in your jurisdiction:

- **Implementation of the Sherman Circle NW Bike/Pedestrian Safety Improvement Plan**

This modification is a result of analysis performed by DDOT to advance recommendations from the Rock Creek East II Livability Study, and from subsequent community engagement. The analysis was presented to the community on July 26, 2017. An executive summary outlining the proposed change to traffic operations was sent to the ANC as an accompaniment to this Notice of Intent.

DDOT's proposed recommendation for Sherman Circle is to reduce one travel lane around the circle, and redesign it to include a variety of treatments to address safety concerns and manage vehicular traffic. These treatments are detailed in the Sherman Circle NW Bike/Pedestrian Safety Improvement Plan, which is attached to this letter. The treatments include:

- Install edgeline and "zebra" curb-stops 10 feet off curb to narrow Circle from two travel lanes to one.
- Install a bicycle lane around the Circle, with a two-foot buffer from the adjacent travel lane. Flexposts will be installed in the buffer where the bicycle lane is not adjacent to on-street parking or a bus stop zone.
- Convert all approaches to the Circle to yield control.
- Install planters on each side of crosswalks adjacent to the Circle park.
- Install high-visibility striping in existing crosswalks.
- Reduce the turning radii at exits of Circle to calm traffic and improve safety at crosswalks.
- Shorten the pedestrian crossing distance at crosswalks.
- Maintain existing parking capacity at the circle.

All comments on this subject matter must be filed in writing, no later than thirty (30) days after the date of this notice, with the District Department of Transportation (DDOT), Planning and Sustainability Division at 55 M Street SE, Washington, DC 20003. Comments may also be sent via email to Ted Van Houten at [theodore.vanhouten@dc.gov](mailto:theodore.vanhouten@dc.gov). To check the status of this Notice of Intent (NOI), please visit DDOT's website at: <http://ddot.dc.gov/service/ddot-notice-intent>

Sincerely,



Jim Sebastian, AICP  
Associate Director  
Planning and Sustainability Division

Attachment: Sherman Circle NW Bike/Pedestrian Safety Improvement Plan

cc: Zach Teutsch, Chairperson, Advisory Neighborhood Commission 4C



# Government of the District of Columbia

## Department of Transportation



September 12, 2017

Lisa Colbert  
Advisory Neighborhood Commission 4D  
601 Gallatin Street NW  
Washington, DC 20011  
[4D03@anc.dc.gov](mailto:4D03@anc.dc.gov)

**Re: Sherman Circle Transportation Safety Improvements**

Dear Chairperson Colbert:

The following letter is being sent in order to update you on the progress of the District Department of Transportation's (DDOT's) work to improve transportation safety at Sherman Circle. A map of the area is shown in Figure 1.

### *Background*

DDOT evaluated Sherman Circle as part of the Rock Creek East II Livability Study, which was completed in 2016. The study recommended the reduction of one travel lane in Sherman Circle to increase pedestrian and bicyclist safety as well as calm traffic.

Residents expressed overall support for the Sherman Circle recommendation in the Livability Study, but the proposed timeline (4-8 years) for full construction of improvements frustrated the community given the immediate desire to slow cars and improve safety. Some residents have expressed concern about reducing a lane at Sherman Circle and the potential impacts on the overall transportation network. In May 2017, ANC 4D Commissioner Amy Hemingway invited DDOT to a site visit at Sherman Circle in response to community concerns about safety. DDOT was asked by the community to explore options to implement improvements at Sherman Circle in the near-term.

DDOT has developed conceptual designs for Sherman Circle and performed an operational analysis on what a reduction to one travel lane would mean for traffic operations at Sherman Circle and in the surrounding neighborhood. The results of the analysis indicated that reducing a travel lane at Sherman Circle would have minimal impacts on traffic flow, vehicular delays, and queues. These results support the feasibility of reducing Sherman Circle to one lane.

At a public meeting on July 26, 2017, DDOT presented the results of the analysis to the community. Community support for reducing Sherman Circle to one lane was mixed. Some residents asked DDOT to perform a trial of the proposed lane reduction at Sherman Circle, an approach that was supported by Councilmember Todd's office and Commissioner Hemingway.

After considering this feedback, DDOT committed to performing this trial, and moved forward with a temporary closure of one lane at Sherman Circle. This closure began on September 11, 2017, and

will be in place for at least three weeks. During this time, DDOT will be collecting additional data and performing site visits and observations. DDOT will analyze the data collected during the trial period and share the results with the community.

*Proposed Recommendations*

DDOT's proposed recommendation for Sherman Circle is to reduce one travel lane around the circle, and redesign it to include a variety of treatments to address safety concerns and manage vehicular traffic. These treatments are detailed in the Sherman Circle NW Bike/Pedestrian Safety Improvement Plan, which is attached to this letter. The treatments include:

- Install edgeline and "zebra" curb-stops 10 feet off curb to narrow Circle from two travel lanes to one.
- Install a bicycle lane around the Circle, with a two-foot buffer from the adjacent travel lane. Flexposts will be installed in the buffer where the bicycle lane is not adjacent to on-street parking or a bus stop zone.
- Convert all approaches to the Circle to yield control.
- Install planters on each side of crosswalks adjacent to the Circle park.
- Upgrade the existing crosswalks around the Circle to ladder markings to improve visibility.
- Reduce the turning radii at exits of Circle to calm traffic and improve safety at crosswalks.
- Shorten the pedestrian crossing distance at crosswalks.
- Maintain existing parking capacity at the circle.

In addition to the improvements outlined above, DDOT is considering the following improvements that could be installed to further calm traffic in the neighborhood, if necessary:

- Install additional flexposts at turns to slow cars exiting the Circle.
- Install additional signage and markings at crosswalks to enhance transportation safety.

DDOT will analyze data collected during the temporary lane closure at Sherman Circle, and will consider all community feedback received. All data and community feedback will be taken into account as DDOT makes a final recommendation.

This letter serves as an accompaniment to the Notice of Intent (NOI) for the above outlined improvements. The NOI has been forwarded to you on the date of this letter, at which time comments will be formally solicited on the intent to modify the operations at this location.

If you have any questions concerning this letter, please feel free to contact Ted Van Houten at [theodore.vanhouten@dc.gov](mailto:theodore.vanhouten@dc.gov) or (202) 671-4580.

Sincerely,



Jim Sebastian, AICP  
Associate Director  
Planning and Sustainability Division

**Attachment: Sherman Circle NW Bike/Pedestrian Safety Improvement Plan**

**cc: Zach Teutsch, Chairperson, Advisory Neighborhood Commission 4C**

**Figure 1: Sherman Circle Area Map**

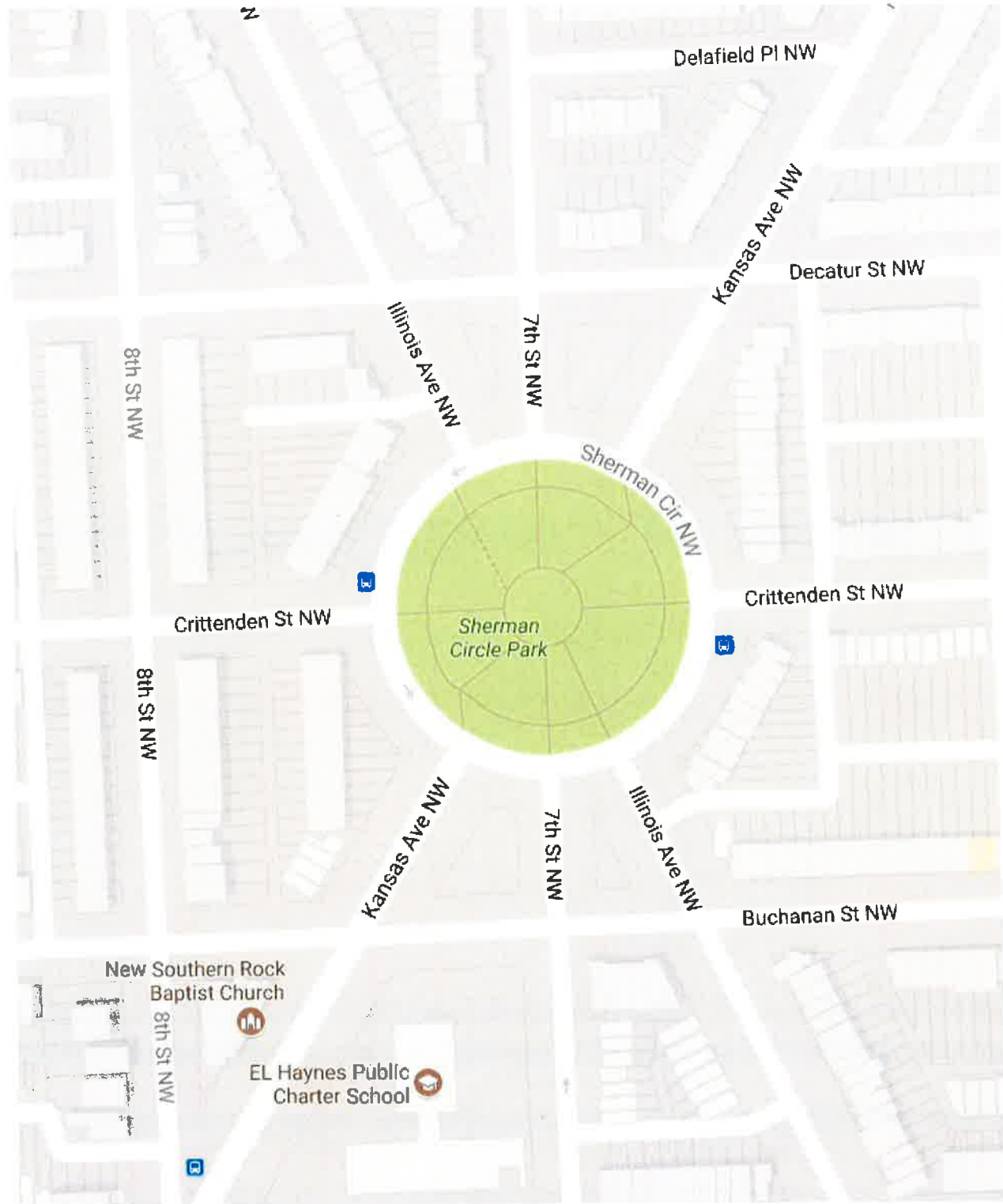

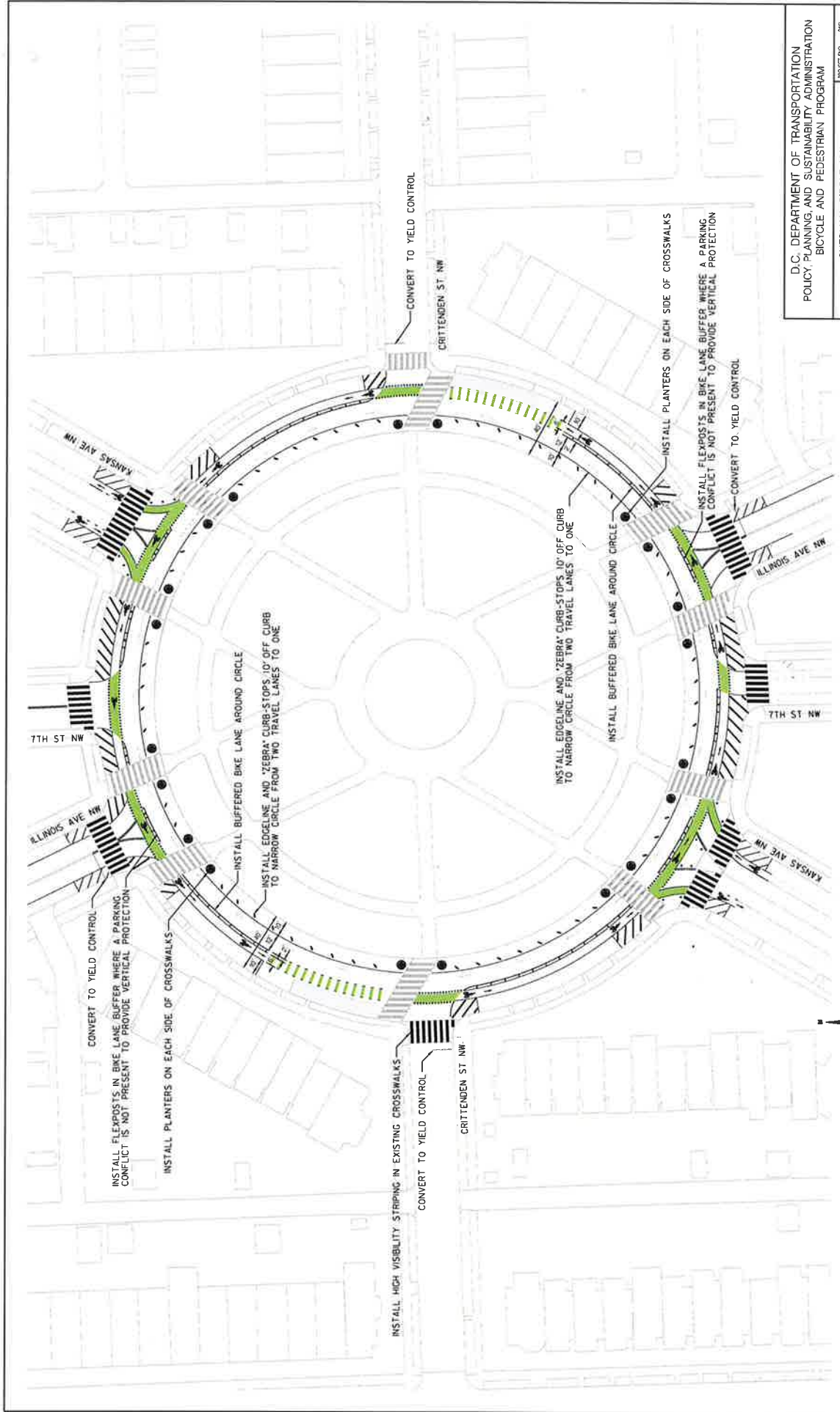

D.C. DEPARTMENT OF TRANSPORTATION  
 POLICY, PLANNING AND SUSTAINABILITY ADMINISTRATION  
 BICYCLE AND PEDESTRIAN PROGRAM

SHERMAN CIRCLE NW  
 BIKE/PEDESTRIAN SAFETY  
 IMPROVEMENT PLAN

PROJECT NO. 000  
 PREPARED BY: J. JACOBS  
 PROJECT DATE: 10/2014  
 DESIGN CHIEF: [Signature]  
 DATE: 10/2014  
 SHEET NO. 001

REVISIONS

NO.	DESCRIPTION	DATE
1	ISSUE FOR PERMIT	10/2014
2	REVISION: CONDITIONAL SIGN FOR BIKES	10/2014
3	CONSTRUCTION SIGN FOR BIKES	10/2014



INSTALL HIGH VISIBILITY STRIPING IN EXISTING CROSSWALKS  
 CONVERT TO YIELD CONTROL

INSTALL BUFFERED BIKE LANE AROUND CIRCLE

INSTALL EDGELINE AND "ZEBRA" CURB-STOPS 10' OFF CURB TO NARROW CIRCLE FROM TWO TRAVEL LANES TO ONE

INSTALL BUFFERED BIKE LANE AROUND CIRCLE

INSTALL EDGELINE AND "ZEBRA" CURB-STOPS 10' OFF CURB TO NARROW CIRCLE FROM TWO TRAVEL LANES TO ONE

INSTALL FLEXPOSTS IN BIKE LANE BUFFER WHERE A PARKING CONFLICT IS NOT PRESENT TO PROVIDE VERTICAL PROTECTION

INSTALL PLANTERS ON EACH SIDE OF CROSSWALKS

CONVERT TO YIELD CONTROL

CONVERT TO YIELD CONTROL

CONVERT TO YIELD CONTROL

CONVERT TO YIELD CONTROL

